

OK
3/1/24

NOTE:-
ALTHOUGH DUE CARE HAS BEEN TAKEN IN APPROVING THE BUILDING PLAN AS PER TECHNICAL NORMS BUT THIS APPROVAL IS NOT PROVIDING ANY RIGHT TO YOU TO VIOLATE ANY RULE/SUBELINES OF THIS DEPARTMENT OR ANY OTHER DEPARTMENT AND ALSO NOT PROVIDE ANY RIGHT FOR ANY ILLEGAL CONSTRUCTION. IN CASE ANY VIOLATION FOUND AT ANY STAGE, YOU SHALL BE LIABLE TO GET THE BUILDING PLAN REVISED ACCORDINGLY IMMEDIATELY.
THE APPROVAL IS SUBJECT TO DECISION OF ANY COURT CASE OCCURRING IN ANY HONBLE COURT OF LAW.

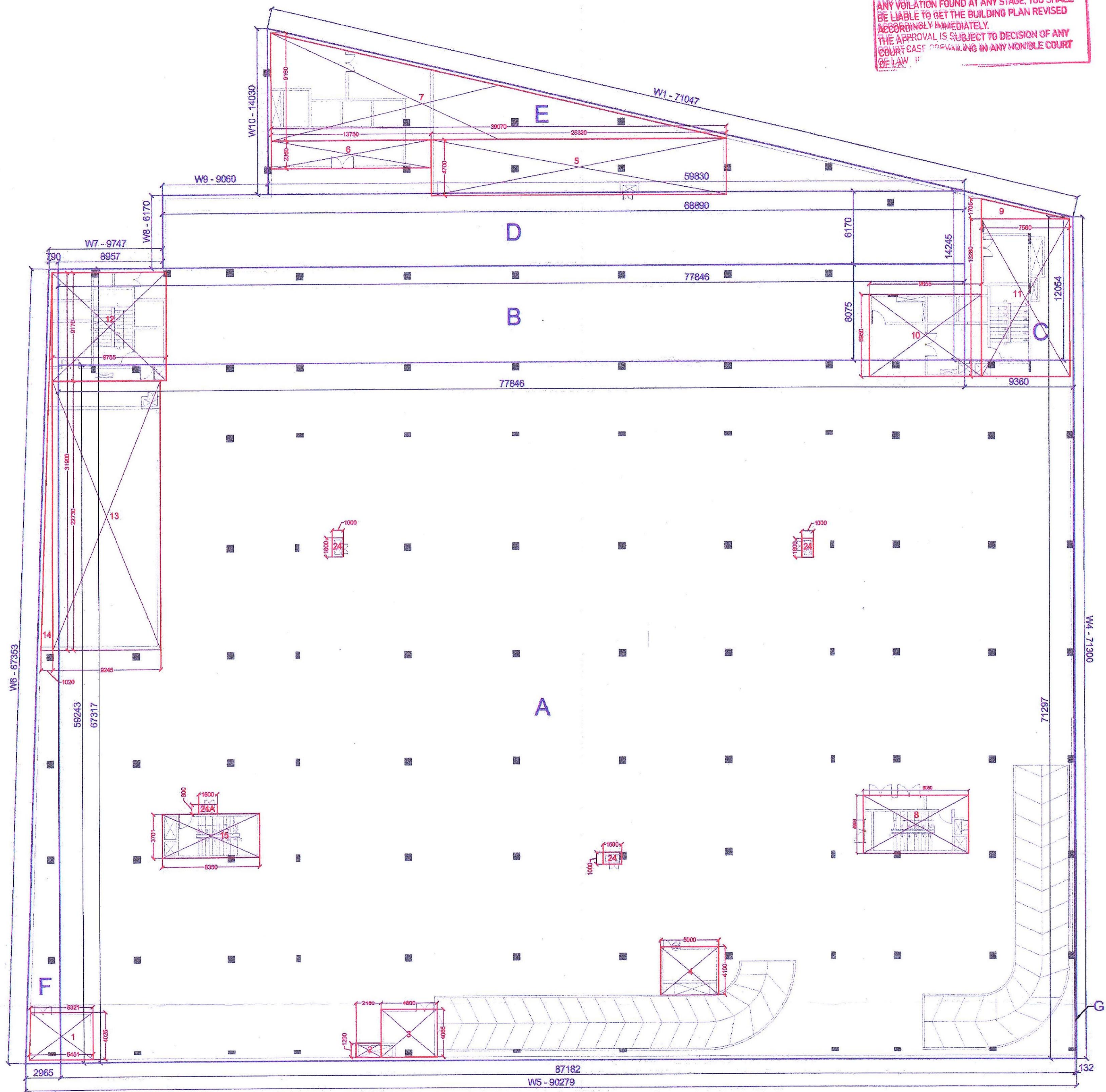

BASEMENT PLAN -3

| BASEMENT -3 AREA DETAIL | | | | | |
|-------------------------------|-------|-----------|--------|--------|--------------|
| S.N.O. | NO. | TYPE | BREATH | LENGTH | AREA IN SQ.M |
| A | 1.00 | RECTANGLE | 87.18 | 59.24 | 5,164.92 |
| B | 1.00 | RECTANGLE | 77.85 | 8.08 | 628.61 |
| C | 9.36 | TRAPEZOID | 12.05 | 14.25 | 123.08 |
| D | 1.00 | RECTANGLE | 68.89 | 6.17 | 425.05 |
| E | 0.50 | TRIANGLE | 59.83 | 14.03 | 419.71 |
| F | 67.32 | TRAPEZOID | 2.97 | 0.79 | 126.39 |
| G | 0.50 | TRIANGLE | 0.13 | 71.30 | 4.71 |
| TOTAL ADDITION - T1 | | | | | 6,892.46 |
| TOTAL BASEMENT-3 NON FAR AREA | | | | | 6,892.46 |

| BASEMENT-3 PARKING AREA | | | | | |
|---------------------------------------|------|-----------|--------|--------|--------------|
| W | NO. | TYPE | BREATH | LENGTH | AREA IN SQ.M |
| W1 | 1.00 | RECTANGLE | 71.05 | 0.30 | 21.31 |
| W4 | 1.00 | RECTANGLE | 71.30 | 0.30 | 21.39 |
| W5 | 1.00 | RECTANGLE | 90.28 | 0.30 | 27.08 |
| W6 | 1.00 | RECTANGLE | 67.35 | 0.30 | 20.21 |
| W7 | 1.00 | RECTANGLE | 9.75 | 0.30 | 2.92 |
| W8 | 1.00 | RECTANGLE | 6.17 | 0.30 | 1.85 |
| W9 | 1.00 | RECTANGLE | 9.06 | 0.30 | 2.72 |
| W10 | 1.00 | RECTANGLE | 14.03 | 0.30 | 4.21 |
| 1.00 | 4.03 | TRAPEZOID | 5.32 | 5.45 | 116.74 |
| 2.00 | 1.00 | RECTANGLE | 2.18 | 1.20 | 2.62 |
| 3.00 | 1.00 | RECTANGLE | 4.80 | 4.07 | 19.51 |
| 4.00 | 1.00 | RECTANGLE | 5.00 | 4.10 | 20.50 |
| 5.00 | 1.00 | RECTANGLE | 25.32 | 4.70 | 119.00 |
| 6.00 | 1.00 | RECTANGLE | 13.75 | 2.36 | 32.45 |
| 7.00 | 0.50 | TRIANGLE | 39.07 | 9.16 | 178.94 |
| 8.00 | 1.00 | RECTANGLE | 9.05 | 4.90 | 44.35 |
| 9.00 | 0.50 | TRIANGLE | 7.56 | 1.71 | 6.44 |
| 10.00 | 1.00 | RECTANGLE | 9.66 | 6.95 | 67.10 |
| 11.00 | 1.00 | RECTANGLE | 7.56 | 13.28 | 100.40 |
| 12.00 | 1.00 | RECTANGLE | 9.76 | 9.17 | 89.45 |
| 13.00 | 1.00 | RECTANGLE | 9.25 | 22.73 | 210.14 |
| 14.00 | 0.50 | TRIANGLE | 1.02 | 31.90 | 16.27 |
| 15.00 | 1.00 | RECTANGLE | 8.35 | 3.70 | 18.58 |
| 24.00 | 3.00 | RECTANGLE | 1.00 | 1.60 | 4.80 |
| 24A | 1.00 | RECTANGLE | 0.80 | 1.60 | 1.28 |
| TOTAL ADDITION - T2 | | | | | 1,150.27 |
| TOTAL BASEMENT-3 PARKING AREA (T1-T2) | | | | | 5,742.19 |

| BASEMENT -3 PARKING DETAIL | AREA IN SQ.M |
|--------------------------------------|--------------|
| BASEMENT -3 AREA | 6892.46 |
| DEDUCTIONS FOR PARKING | 1150.27 |
| BASEMENT-3 BALANCE AREA FOR PARKING | 5742.19 |
| TOTAL BALANCE AREA FOR PARKING | 5742.19 |
| BASEMENT-3 PARKING ECS @32 SQ.M | 179.44 |
| TOTAL NO'S CAR PARKING IN BASEMENT-3 | 179.44 |

THESE BUILDING PLANS ARE ISSUED
VIDE LETTER NO. EQ/GMADA/... DATED 18/08/25
3794

Technically Approved
(From Town Planning Point of View)
Wide Letter No. 15
DTP(S)/... Dated 02/01/2024

District Town Planner, S.A.S. Nagar

State Officer (H)
GMADA, S.A.S. Nagar

NOTE:-
1. BUILDING IS FULLY SPRINKLERS AND FULLY MECHANICALLY VENTILATED, ARTIFICIALLY LIGHTED WITH 100% POWER BACKUP AS PER NBC NORMS
2. ALL RAILINGS ARE 1000MM IN HEIGHT.

CYBER SQUARE
SITE NO I & II SHOPPING COMPLEX
PHASE -IX EXPANSION INDUSTRIAL
FOCAL POINT SAS NAGAR MOHALI

| | |
|---|------------------------|
| OWNER'S SIGNATURE: | ARCHITECT'S SIGNATURE: |
| <i>Navmeet Sarin</i> | <i>Navmeet Sarin</i> |
| NAVMEET SARIN CA NO. CA/90/13495 | |
| DRAWING TITLE: BASEMENT-3 FAR DETAIL SHEET | DATE: 28.12.2024 |
| DRAWING NUMBER: A-07 | SCALE: 1:200 |